

Waiting Restrictions
Merlin Crescent
St. Bride's Avenue

Draft Traffic Management Order
Notice of intentions

Consultation Period
21st November 2024
to
12th December 2024

Statement of reasons:

Waiting restrictions are proposed in Merlin Crescent and St. Brides Avenue to improve safety by preventing vehicles from parking within the vicinity of a new pedestrian crossing.

Project Officer: Nabeel Shahid

London Borough of Harrow

The Harrow (Waiting and Loading Restrictions) (Amendment No. *) Traffic Order 202*

1. NOTICE IS HEREBY GIVEN that the Council of the London Borough of Harrow proposes to make the above-mentioned Order under Sections 6, 124 and Part IV of Schedule 9 of the Road Traffic Regulation Act 1984 as amended by the Local Government Act 1985 and all other enabling powers.
2. The general effect of the Order would be to introduce "At Any Time" Waiting Restrictions in certain lengths of Merlin Crescent and St. Bride's Avenue.
3. A copy of the proposed Order and of the Council's statement of reasons for proposing to make the Order can be inspected until the expiration of a period of 21 days from the date on which this notice is published at Greenhill Library, Perceval Square, College Road, Harrow, HA1 1GX between 10.00 a.m. and 6.00 p.m. Monday to Saturday and 11.00 a.m. and 3.00 p.m. Sunday, excluding Bank Holidays.
4. Further information may be obtained by contacting the Transportation Service at transportation@harrow.gov.uk.
5. Persons desiring to object to the proposed Orders should send a statement in writing of their objection and the grounds thereof, to the Head of Traffic, Highways and Asset Management at transportation@harrow.gov.uk quoting reference 24-16-2, before the aforementioned date.

Dated 21st November 2024

Poonam Pathak
Strategic Head of Traffic, Highways and Asset Management
Place Directorate, PO Box 1362, Harrow, HA3 3RL

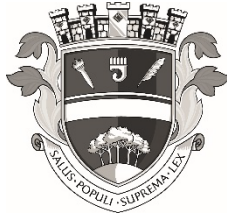

LONDON BOROUGH OF **HARROW**

TRAFFIC MANAGEMENT ORDER

20** No. *

The Harrow (Waiting and Loading Restriction) (Amendment No. *) Traffic Order 20**

Made **

Coming into operation **

The Council of the London Borough of Harrow, after consulting the Commissioner of Police for the Metropolis, in exercise of the powers conferred by sections 6, 124, and Part IV of Schedule 9 to the Road Traffic Regulation Act 1984(a) and of all other powers thereunto enabling, hereby make the following Order:-

1. This Order shall come into operation on *** and may be cited as The Harrow (Waiting and Loading Restriction) (Amendment No.***) Traffic Order 20**.
2. In this Order the expression “enactment” means any enactment, whether public general or local, and includes any order, byelaw, rule, regulation, scheme or other instrument having effect by virtue of an enactment and any reference in this Order to any enactment shall be construed as a reference to that enactment as amended, applied, consolidated, re-enacted by or as having effect by virtue of any subsequent enactment.
3. Without prejudice to the validity of anything done or to any liability incurred in respect of any act or omission before the coming into operation of this Order, the Harrow (Waiting and Loading Restriction) Traffic Order 2014(c) shall have effect as though for the items in Schedule 1 to that Order numbered 614 and 784 there were substituted the items similarly numbered and set out in columns 1, 2 and 3 of the Schedule to this Order.

Dated this ** day of ** 20**

Poonam Pathak
Strategic Head of Traffic, Highways and Asset Management
(the officer appointed for this purpose)

(a) 1984 c.27

(b) 1985 c.51

(c) LBH2014/40

SCHEDULE

1 Item No.	2 Street	3 Prescribed hours see Schedule 3
614	<p>Merlin Crescent</p> <p>(a) the kerb-line fronting the even numbered properties,</p> <p>(i) between the north-western kerb-line of Camrose Avenue and a point 14.00 metres north-west of that kerb-line;</p> <p>(ii) between a point 4.20 metres north-west of a point opposite the party wall of Nos. 30 and 32 Merlin Crescent and a point 5.50 metres north of a point opposite the party wall of Nos. 50 and 52 Merlin Crescent;</p> <p>(iii) from a point 5.50 metres north of a point opposite the party wall of Nos. 50 and 52 Merlin Crescent to a point 3.20 metres north of a point opposite the common boundary of Nos. 54 and 56 Merlin Crescent;</p> <p>(iv) between a point 17.00 metres north-east of a point opposite the party wall of Nos. 136 and 138 Merlin Crescent and its junction with Buckingham Road;</p> <p>(b) the kerb-line fronting the odd numbered properties,</p> <p>(i) between the north-western kerb-line of Camrose Avenue and a point 14.00 metres north-west of that kerb-line;</p> <p>(ii) between a point 2.70 metres north-west of a point opposite the party wall of Nos. 30 and 32 Merlin Crescent and a point 2.00 metres south of a point opposite the northern wall of No. 37 Merlin Crescent;</p> <p>(iii) between a point opposite the party wall of Nos. 78 and 80 Merlin Crescent and a point 0.50 metres south-west of a point opposite the party wall of Nos. 59 and 61 Merlin Crescent;</p> <p>(iv) between a point opposite the southern wall of No. 112 Merlin Crescent and a point 2.00 metres north of a point opposite the party wall of Nos. 120 and 122 Merlin Crescent;</p> <p>(v) between a point 16.00 metres north-east of a point opposite the party wall of Nos. 132 and 134 Merlin Crescent and its junction with Buckingham Road;</p> <p>(vi) the island site at the junction of St. Bride's Avenue.</p>	<p>A</p> <p>A</p> <p>CG</p> <p>A</p> <p>A</p> <p>A</p> <p>A</p> <p>A</p> <p>A</p> <p>A</p> <p>A</p>
784	<p>St. Bride's Avenue</p> <p>(a) the west side,</p> <p>(i) between its junction with Merlin Crescent and a point 4.20 metres south west of a point opposite the common boundary of Nos. 6 and 8 St. Bride's Avenue;</p> <p>(ii) between the north-western kerb-line of Camrose Avenue and a point 14.50 metres north-west of that extended kerb-line;</p> <p>(b) the east side,</p> <p>(i) between its junction with Merlin Crescent and a point 6.80 metres north east of a point opposite the northern boundary of No. 1 St. Bride's Avenue;</p> <p>(ii) between the extended north-western kerb-line of Camrose Avenue and a point 14.50 metres north-west of that kerb-line.</p>	<p>A</p> <p>A</p> <p>A</p> <p>A</p>

EXPLANATORY NOTE

(This Note is not part of the Order but is intended to indicate its general purport.)

This Order further amends the Harrow (Waiting and Loading Restriction) Order 2014, so that the restrictions imposed by that Order on vehicles, with certain exceptions, with regard to waiting, the offer or exposure for sale of goods from vehicles and on advertising activities in certain streets in the London Borough of Harrow, now apply in additional lengths of Merlin Crescent and St. Bride's Avenue.

SAFETY, HEALTH AND ENVIRONMENTAL INFORMATION
It is advised that the contractor should consult with the police and local authority regarding any road closures.
CONSTRUCTION
PROPOSED WORKS CONTAINED ON THESE PLANS ARE SUBJECT TO THE PROVISIONS OF THE CONSTRUCTION INFORMATION DESIGN AND ACCESSIBILITY REGULATIONS 2015.
MAINTENANCE/CLEANING
NOTE
DECOMMISSIONING/DEMOLITION
NOTE
It is assumed that the works will be carried out by a competent contractor working, where appropriate, to an approved method statement.
KEY
PROPOSED 'NO PARKING AT ANY TIME' RESTRICTIONS
PROPOSED 'NO PARKING' RESTRICTIONS
SETTING OUT MARKERS
NOTES:
1. THIS DRAWING IS TO BE READ IN CONJUNCTION WITH THE WORKS PACK, THE BILL OF MATERIALS, LAM SPECIFICATION AND THE FOLLOWING DRAWINGS: <ul style="list-style-type: none"> • DRAWING: 120-00001 • DRAWING: 120-00002 • DRAWING: 120-00003 • DRAWING: 120-00004
2. THE LOCATION OF STATUTORY INSTRUMENTS APPROPRIATE SHOULD BE PROVIDED BY THE CONTRACTOR BEFORE UNDERTAKING ANY WORK.
3. ALL CHANGING ARE IN METRES UNLESS OTHERWISE SPECIFIED.
4. ALL STREET FURNITURE TO HAVE A MINIMUM CLEARANCE OF 4000MM FROM THE CHANGING.
5. ALL ROAD MARKINGS ARE TO BE SET OUT IN ACCORDANCE WITH T.S.R.D. 2016. PROPOSED MARKINGS ARE SHOWN IN GREY IN THIS PLAN. EXISTING ROAD MARKINGS ARE SHOWN IN GREY. ALL ROAD MARKINGS SHOWN ARE TO BE REPRODUCED.
6. THIS DRAWING IS BASED ON SURVEYING AND SETS MEASUREMENTS.

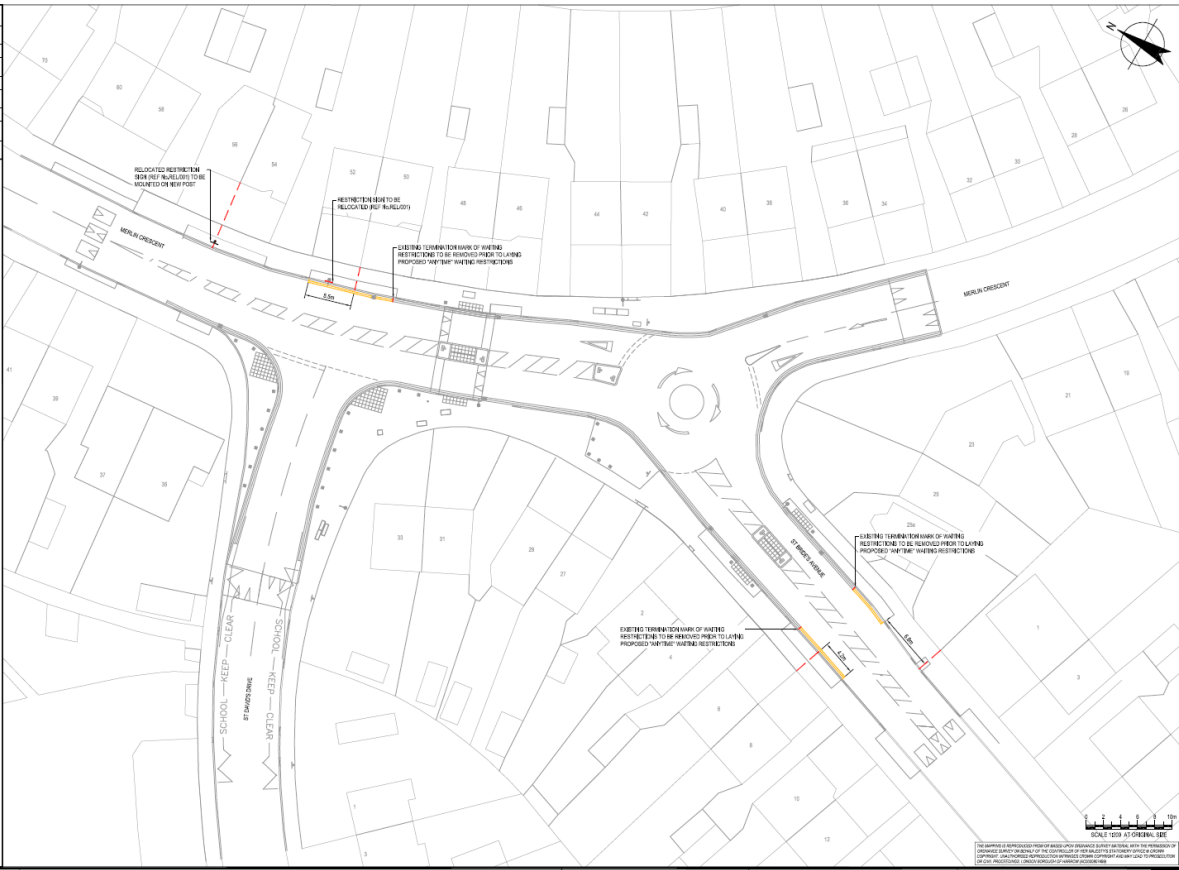

REV	DESCRIPTION	DATE	BY	CHECKED
1	ISSUED FOR TENDER	12/08/24	KL	GL
2	ISSUED FOR CONSTRUCTION	12/08/24	KL	GL

Author	KL WHEELER	Design Check	GL WARDLECK
Designer	KL WHEELER	Design Check	GL WARDLECK

GHD
 25th Floor, 100 Broad Street, London, EC2M 2ES, UK
 T: +44 (0)20 7676 4000
 F: +44 (0)20 7676 4100
 www.ghd.com

Client: **LONDON BOROUGH OF HARROW**
 Project: **MERLIN CRESCENT**

Drawing Title: **RESTRICTION EXTENSIONS GENERAL ARRANGEMENT PLAN**
 Status: **REVIEW & COMMENT**
 Table Code: **S3**
 Drawing No: **12610667-GHD-HGN-MRL-DR-U-00002**
 Rev: **P02**